

INSTALLATION GUIDE

SPLICE SEAL™



REBAR SPLICE PROTECTOR SLEEVE



US Patent #6,265,065

Unlike epoxy patching, there is no ambient temperature limitation to consider and no hazardous waste disposal when you use SpliceSeal™

SPLICE SEAL™



REBAR SPLICE PROTECTOR SLEEVE



US Patent #6,265,065

SpliceSeal™ Shrink Tube Protector is a corrosion protector sleeve for rebar. Used primarily for mechanical coupler reinforcement systems for black bar or epoxy coated rebar systems used in any concrete structure, bridges, or heavy highway paving.

SpliceSeal™ is an engineered composite material with specially formulated glue that bonds to the rebar with or without epoxy. This allows fast and efficient sealing of joined reinforced bars, lapped, welded, or joined with mechanical couplers without the use of volatile epoxy coatings.

THE INSTALLATION PROCESS



1. Slide SpliceSeal™ tube onto rebar prior to coupling.



2. Connect Coupler then, preheat intended SpliceSeal™ area to be covered.

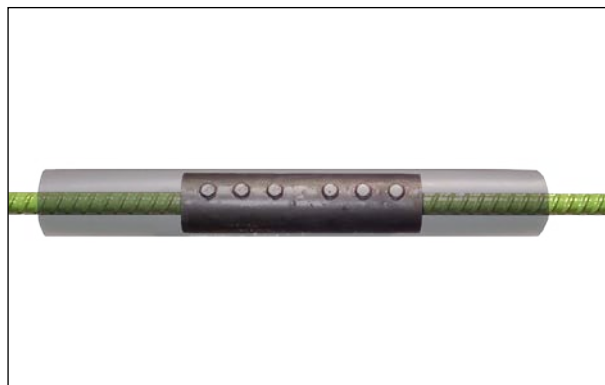

3. Slide SpliceSeal™ an equal length of a min. 3" on both sides of the coupler. Temporarily secure using tape or tie wire.



4. Warm SpliceSeal with a "rose bud heating torch tip". Evenly distribute heat throughout the circumference of the SpliceSeal™ by constantly moving torch. Make sure not to burn the SpliceSeal™



130 Los Aguajes Ave., Santa Barbara, CA 93101
(805) 456-5980
info@rjdindustries.com



SPLICE SEAL™

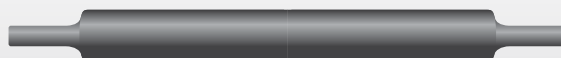

REBAR SPLICE PROTECTOR SLEEVE

AFTER REBAR COUPLING OR REPAIRING DAMAGED REBAR EPOXY COATINGS



1. Select the SpliceSeal™ size based on the diameter of bar and/or coupler being sealed. Cut the selected SpliceSeal™ lengthwise in order to slip over existing repair area.
2. Center the SpliceSeal™ over the area to be covered and temporarily secure with tape or tie wire.
3. See "The Heating Process" section to complete the SpliceSeal™ protection. Note: If damaged area is longer than the selected SpliceSeal™, use as many of the selected units as necessary to cover the damaged area.

Note: Overlap the units a minimum of 3 inches.

SEALING REBAR END CORROSION

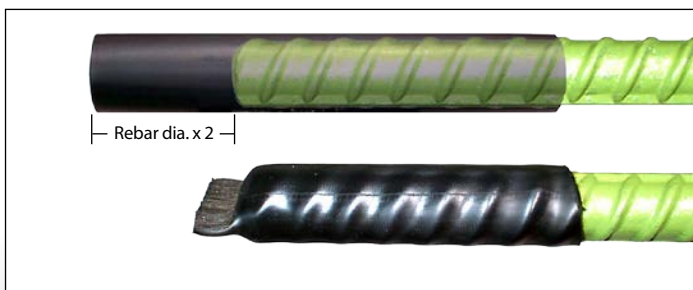

1. Multiply rebar diameter 2x to equal overhang length.
2. Temporarily secure SpliceSeal™ using tape or tie wire.
3. See "The Heating Process" section.
4. While still hot, pinch the loose end of the SpliceSeal™ with pliers to ensure closure. Trim if necessary.

THE HEATING PROCESS



Heating Source: There are many options when choosing a heat gun. Milwaukee #8980 Heat Gun (Electrical) or Bernz-O-Matic "Sure-Fire" T751 (Propane) are two of the many heat gun options available today.

Pre-Heating Process: The portions of the bar and coupler that will be in contact with the **SpliceSeal™**, should be pre-heated to a minimum of 212° F (100° C).

Max Temp: The epoxy coating on the reinforcement should not be heated above 250° F (121° C).

Timing: **SpliceSeal™** should be applied before the pre-heated area has cooled below the minimum pre-heat temperature.

Uniform Heating: Heat from the center of the spliced region outward until the tubing is completely shrunk and the mastic material is protruding from both ends of the tubing. Insure the heating method does not burn or damage the **SpliceSeal™**.

Cold Weather Conditions: For larger sized bar, or during cold weather periods, any "soft flame" source, such as a rose bud tip used with oxyacetylene, may be used.



SPLICE SEAL™



REBAR SPLICE PROTECTOR SLEEVE



130 Los Aguajes Ave., Santa Barbara, CA 93101 • (805) 456-5980 • rjdindustries.com

| STANDARD COUPLER TYPE | REBAR SIZE | SPLICE SEAL CODE | SPLICE SEAL DESCRIPTION |
|---|------------|------------------|---------------------------------|
| BarSplice BarGrip XL | 3, 4 | SS-1.1x12 | SpliceSeal 1.1" id by 12" long |
| | 5, 6 | SS-1.5x12 | SpliceSeal 1.5" id by 12" long |
| | 7, 8, 9 | SS-2.0x16 | SpliceSeal 2.0" id by 16" long |
| | 10, 11 | SS-3.0x16 | SpliceSeal 3.0" id by 16" long |
| | 14 | SS-3.0x24 | SpliceSeal 3.0" id by 24" long |
| | 18 | SS-4.3x24 | SpliceSeal 4.3" id by 24" long |
| Dayton Barlock "L" Series | 4, 5 | SS-2.0x12 | SpliceSeal 2.0" id by 12" long |
| | 6, 7 | SS-2.0x16 | SpliceSeal 2.0" id by 16" long |
| | 8 | SS-3.0x24 | SpliceSeal 3.0" id by 24" long |
| | 9, 10, 11 | SS-3.5x24 | SpliceSeal 3.5" id by 24" long |
| | 14 | SS-4.3x32 | SpliceSeal 4.3" id by 32" long |
| Erico's Lenton Standard (A2) Taper Threaded | 4 | SS-1.1x6 | SpliceSeal 1.1" id by 6" long |
| | 5 | SS-1.1x8 | SpliceSeal 1.1" id by 8" long |
| | 6 | SS-1.5x8 | SpliceSeal 1.5" id by 8" long |
| | 7, 8 | SS-1.5x12 | SpliceSeal 1.5" id by 12" long |
| | 9, 10, 11 | SS-2.0x12 | SpliceSeal 2.0" id by 12" long |
| | 12 | SS-2.75x12 | SpliceSeal 2.75" id by 12" long |
| | 14 | SS-3.0x12 | SpliceSeal 3.0" id by 12" long |
| | 18 | SS-3.5x16 | SpliceSeal 3.5" id by 16" long |
| HRC 500/510 Series | 4 | SS-1.5x8 | SpliceSeal 1.5" id by 8" long |
| | 5, 6 | SS-2.0x8 | SpliceSeal 2.0" id by 8" long |
| | 7 | SS-2.0x095 | SpliceSeal 2.0" id by 9.5" long |
| | 8, 9 | SS-3.0x095 | SpliceSeal 3.0" id by 9.5" long |
| | 10 | SS-3.0x12 | SpliceSeal 3.0" id by 12" long |
| | 11 | SS-3.5x12 | SpliceSeal 3.5" id by 12" long |
| | 14 | SS-4.3x12 | SpliceSeal 4.3" id by 12" long |
| | 18 | SS-4.3x16 | SpliceSeal 4.3" id by 16" long |

For different coupler types and manufacturers, please contact RJD Industries for SpliceSeal™ size(s).



Technical questions: info@rjdindustries.com

Splice Seal is sold exclusively through quality construction materials dealers. Scan the QR code to see our distributor locations or just call us for the name of the dealer nearest you.



SpliceSeal™ does not contain hazardous wastes requiring disposal. SpliceSeal™ has been approved by U.S. DOT and Canadian Government Engineering Divisions. Exclusion apply call us for more information.